



HDSRCD35-2



HDSRCD47-2



HDSRCD59-2



HDSRCD70-2

**STANDARD FEATURES**

- Refrigeration system maintains temperatures between 36°F and 43°F ( 2°C to 6°C).
- Exterior: Stainless steel floor and walls, standard.
- Sliding doors.
- 12V LED lighting system, safe for users to operate.
- Tempered glass to avoid injury by broken glass. Preinstalled hidden caster design.
- NSF-7 compliant for open food product.
- Shelves: Adjustable glass shelves provide extra large viewing area to maximize bakery product presentation.
- Electronic control system makes it easy to adjust temperature set point and defrost frequency.
- Slide out refrigeration condensing unit makes it easy to access condenser for cleaning and service.
- Option of HYDRO-CARBON R290 refrigerant available.

**HDSRCD35-2**

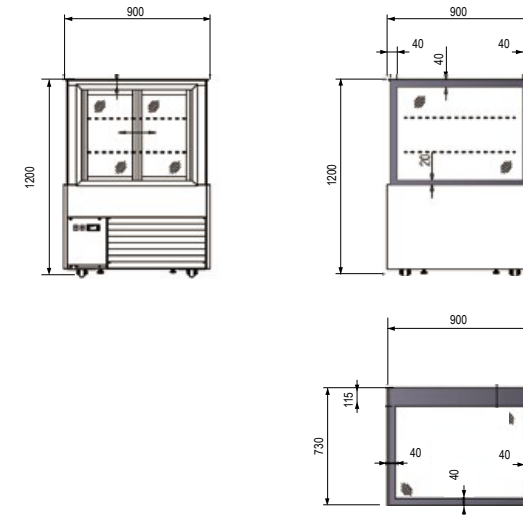

**HDSRCD47-2**

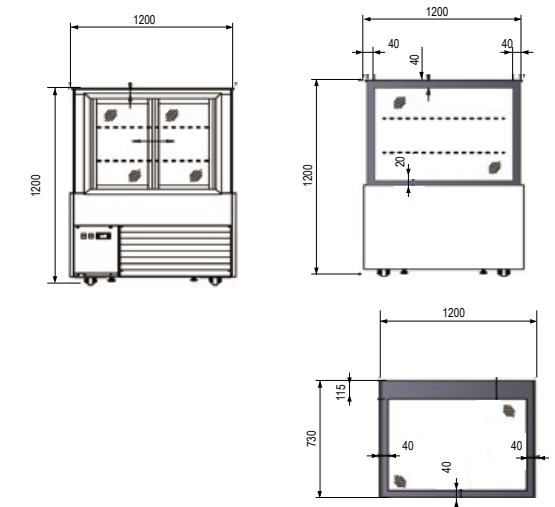

**HDSRCD59-2**

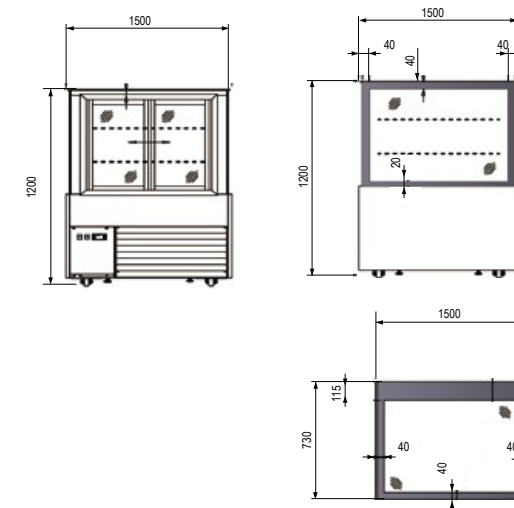

**HDSRCD70-2**

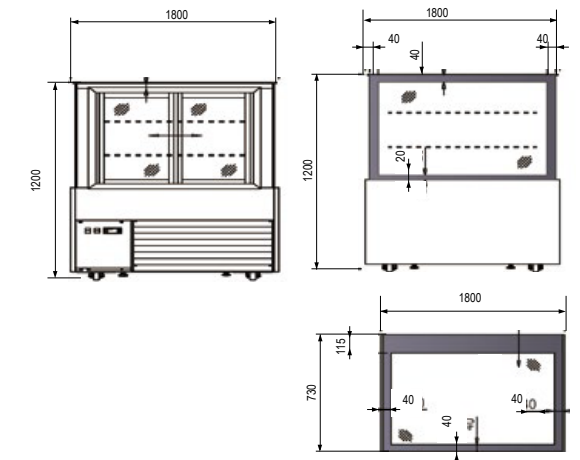

MODEL	DOORS	SHELVES	DIMENSIONS	CAPACITY	HP	AMPS	VOLTAGE	PLUG TYPE
HDSRCD35-2	2	2	35 3/8 x 28 3/4 x 47 1/4 in 900 x 730 x 1200 mm	11.3 cu.ft. 320 liters	1/3+	6.9	115/60/1	NEMA 5-15P
HDSRCD47-2	2	2	47 1/4 x 28 3/4 x 47 1/4 in 1200 x 730 x 1200 mm	14 cu.ft. 400 liters	1/3+	7.2	115/60/1	NEMA 5-15P
HDSRCD59-2	2	2	59 1/8 x 28 3/4 x 47 1/4 in 1500 x 730 x 1200 mm	17.7 cu.ft. 500 liters	1/2+	8.1	115/60/1	NEMA 5-15P
HDSRCD70-2	2	2	70 7/8 x 28 3/4 x 47 1/4 in 1800 x 730 x 1200 mm	21.2 cu.ft. 600 liters	1/2+	8.3	115/60/1	NEMA 5-15P

sales@heavydutysystems.com

Voltage 220/50/1 available.



HDSRCD35-3



HDSRCD47-3



HDSRCD59-3



HDSRCD70-3

**STANDARD FEATURES**

- Refrigeration system maintains temperatures between 36°F and 43°F ( 2°C to 6°C).
- Exterior: Stainless steel floor and walls, standard.
- Sliding doors.
- 12V LED lighting system, safe for users to operate.
- Tempered glass to avoid injury by broken glass. Preinstalled hidden caster design.
- NSF-7 compliant for open food product.
- Shelves: Adjustable glass shelves provide extra large viewing area to maximize bakery product presentation.
- Electronic control system makes it easy to adjust temperature set point and defrost frequency.
- Slide out refrigeration condensing unit makes it easy to access condenser for cleaning and service.
- Option of HYDRO-CARBON R290 refrigerant available.

**HDSRCD35-3**

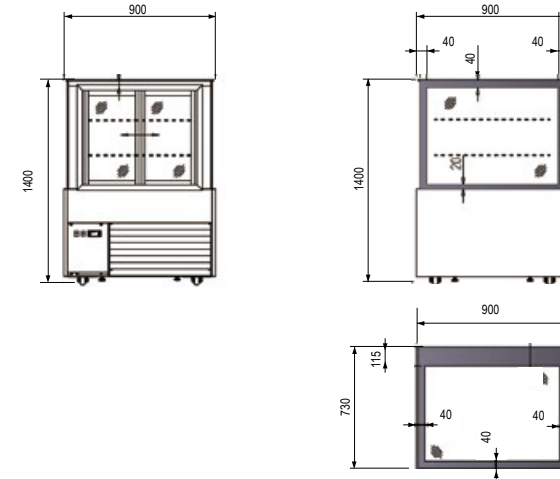

**HDSRCD47-3**

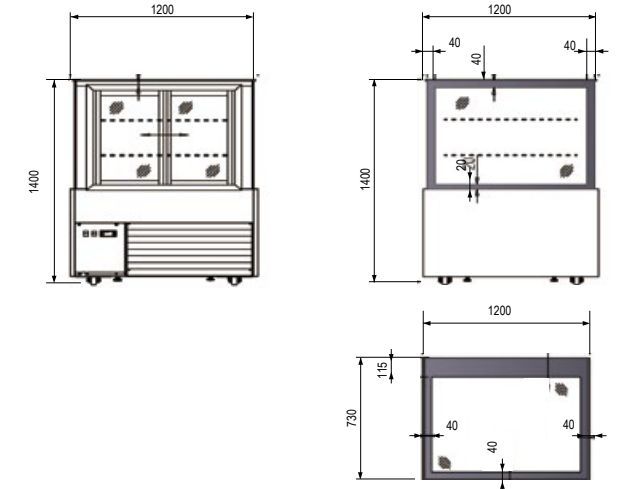

**HDSRCD59-3**

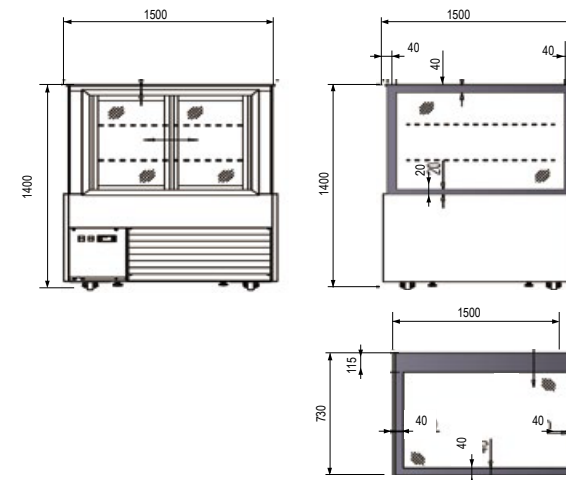

**HDSRCD70-3**

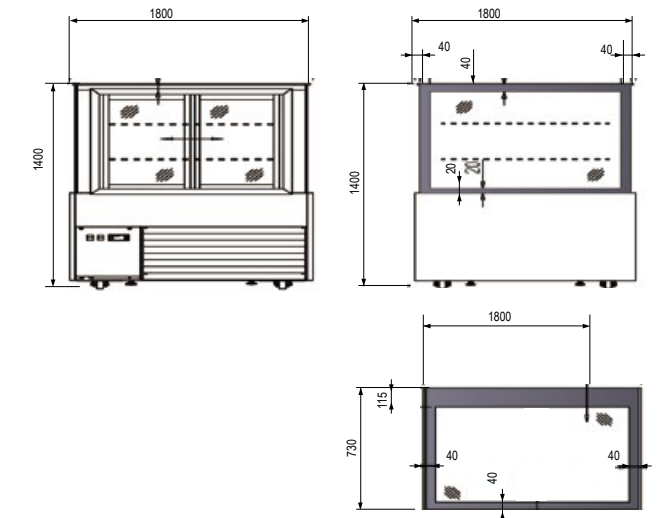

MODEL	DOORS	SHELVES	DIMENSIONS	CAPACITY	HP	AMPS	VOLTAGE	PLUG TYPE
HDSRCD35-3	2	3	35 3/8 x 28 3/4 x 55 1/8 in 900 x 730 x 1400 mm	12.7 cu.ft. 360 liters	1/3+	7.3	115/60/1	NEMA 5-15P
HDSRCD47-3	2	3	47 1/4 x 28 3/4 x 55 1/8 in 1200 x 730 x 1400 mm	19.4 cu.ft. 550 liters	1/3+	7.3	115/60/1	NEMA 5-15P
HDSRCD59-3	2	3	59 1/8 x 28 3/4 x 55 1/8 in 1500 x 730 x 1400 mm	25 cu.ft. 700 liters	1/2+	8.3	115/60/1	NEMA 5-15P
HDSRCD70-3	2	3	70 7/8 x 28 3/4 x 55 1/8 in 1800 x 730 x 1400 mm	30 cu.ft. 850 liters	1/2+	8.5	115/60/1	NEMA 5-15P

sales@heavydutysystems.com

Voltage 220/50/1 available.